

Double Square x Double-D Adapters

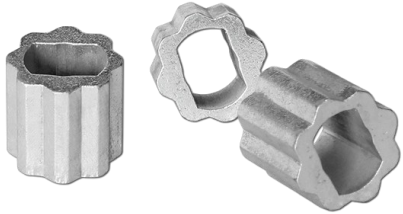

- 17mm x 0.563" x 0.375"
- 22mm x 0.563" x 0.375"
- 22mm x 0.625" x 0.438"
- 22mm x 0.750" x 0.500"
- 27mm x 0.625" x 0.438"
- 27mm x 0.750" x 0.500"
- 27mm x 0.875" x 0.625"
- 36mm x 0.750" x 0.500"
- 36mm x 0.875" x 0.625"
- 17mm x 14mm x 11mm
- 27mm x 25mm x 19mm
- 36mm x 28mm x 22mm

Sleeve Adapters [outside x inside]

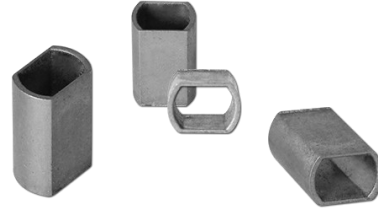

- [1.181" x 0.866"] x [0.875" x 0.625"]-A
- [1.181" x 0.866"] x [0.750" x 0.500"]-B
- [0.750" x 0.500"] x [0.625" x 0.438"]-C
- [0.750" x 0.500"] x [0.563" x 0.375"]-D

Produced in sintered carbon steel, stainless steel and from stainless bar stock, you are sure to locate an adapter which meets your needs.

Contact us for more information today!